

LOC	DIST	REVISIONS					
AL	2	P	LTR	DESCRIPTION	DATE	DWN	APVD
			N	New drawing released	26NOV2008	J.S	P.E.G
			N1	REVISED PER ECO-09-026495	17DEC2009	KK	AEG

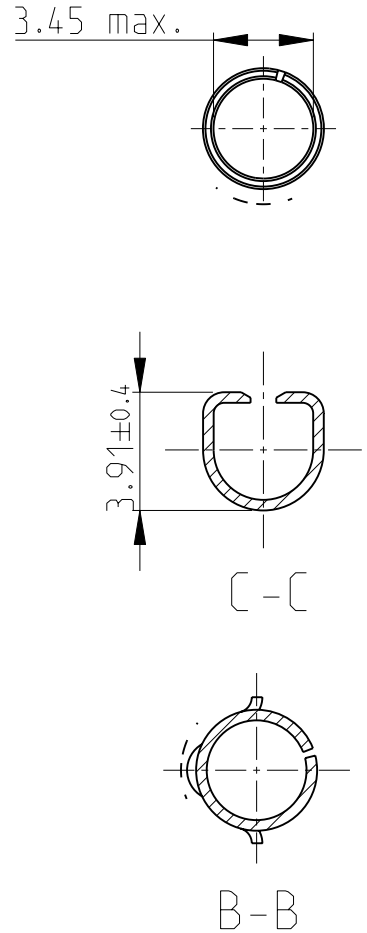
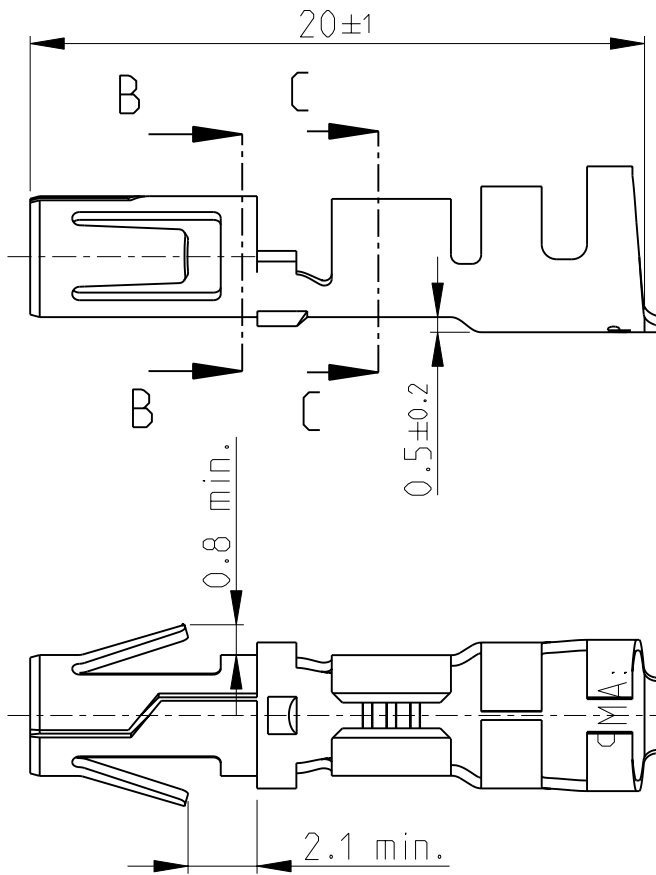

NOTE:

1 OBSOLETE PARTS: OBSOLETE CIS STREAMLINING PER D.RENAUD/D.SINISI

DGB	Insulation \emptyset	Material	Finish	Part no.	
1 OBSOLETE	2.1-5.3mm ²	max. 4.5mm	Bronze	None	925663-5
	2.1-5.3mm ²	max. 4.5mm	Bronze	Plain	925663-4
	2.1-5.3mm ²	max. 4.5mm	Bronze	Silver	925663-3
	2.1-5.3mm ²	max. 4.5mm	Bronze	Pre-tin	925663-2
	2.1-5.3mm ²	max. 4.5mm	Brass	Pre-tin	925663-1

2008

RELEASED FOR PUBLICATION

THIS DRAWING IS UNPUBLISHED.

© COPYRIGHT 2008 BY TYCO ELECTRONICS CORPORATION. ALL RIGHTS RESERVED.

DIMENSIONS: mm	DWN J. Salo 26NOV2008	MATERIAL -	FINISH -
TOLERANCES UNLESS OTHERWISE SPECIFIED:	CHK R. Sole 26NOV2008	Tyco Electronics Corporation Barcelona. Spain.	
0 PLC ±-	APVD P.E.Grassano 26NOV2008		
1 PLC ±-	PRODUCT SPEC	NAME .140 DIA SOCKET	
2 PLC ±0.4	APPLICATION SPEC	SIZE A 4	CAGE CODE -
3 PLC ±-		DRAWING NO C-925663	RESTRICTED TO -
4 PLC ±-		WEIGHT -	
ANGLES ±1° 30'		CUSTOMER DRAWING	SCALE 4:1
		SHEET 1 OF 1	REV N1